

JA-111M Bus magnetic mini detector

The product is a component of the **JABLOTRON JA-100 system**. It is used for the detection of opening doors, windows, etc. The detector has a status reaction (reports its activation and deactivation). It should be installed by a trained technician with a valid certificate issued by an authorized distributor.

Installation

Select the right location for the detector. The permanent magnet (10) can be on the left or on the right side of the detector. The part with the transmitter is mounted on the fixed part of the door (windows) and the magnet on the moving part. You should avoid installation on metal things (it could have a negative influence on the detector functioning).

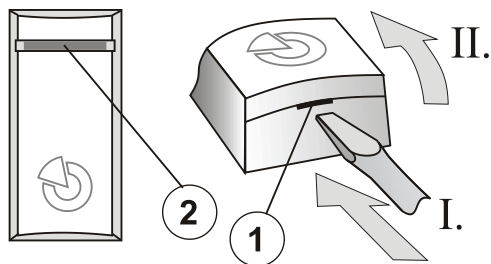

Fig: 1 – cover tab; 2 – LED indicators (yellow and red)

1. Open the detector cover by pushing the tab (1).
2. Select the right hole for the cable in the back part of the cover and break the membrane, put the cable thru and screw the detector onto the chosen place.



When connecting the module to the system bus, always switch the power off.

3. Connect the bus cables (3) to the terminals (6).

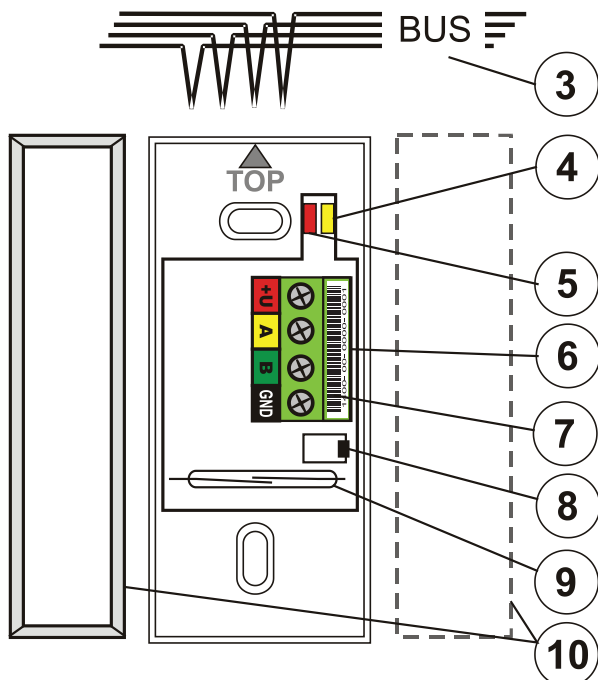

Fig: 3 – bus cable; 4 – yellow fault indicator; 5 – red detector activation indicator; 6 – digital bus terminals; 7 – production code; 8 – tamper contact; 9 – magnetic sensor; 10 – permanent magnet with its alternative position

4. Proceed according to the control panel installation manual. Basic procedure:
 - a. When the device is powered, the yellow LED starts flashing repeatedly to indicate that the module has not been enrolled into the system.

- b. Go to the **F-Link** software, select the required position in the **Devices** window and launch enrollment mode by clicking on the **Enroll** button.
 - c. Open the detector cover and press the tamper contact (8) – the module is enrolled and the yellow LED goes off.
5. Close the detector cover.

Internal settings of the detector

The detector properties can be set in the **Devices** tab of the **F-Link** software. When at the detector position, use the **Internal settings** option to open a dialog window where you can set:

(* default settings)

LED indication enabled* / disabled: Allows the user to disable activation indication with a red LED.

Note:

- The detector can also be enrolled into the system by entering its production code (7) in the **F-Link** software or on a keypad (or using a bar code scanner). All numbers stated under the bar code shall be entered (1400-00-0000-0001).
- The distance between the transmitter and the permanent magnet should be the shortest when the door is closed. For a diagram of the activation distances in all of axis see the picture below. Distances are valid for position on non-magnetic materials.

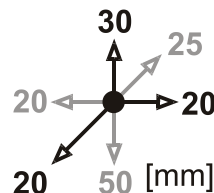

Technical specifications

Power	from control panel bus 12 V (9...15 V)
Current consumption in standby mode	5 mA
Current consumption for cable choice	5 mA
Dimensions	55 x 27 x 16 mm
Classification	Grade 2
according to	EN 50131-1, EN 50131-2-6
Operational environment	
according to	EN 50131-1 II. Indoor general
Operating temperature range	-10 to +40 °C
Also complies with	EN 50130-4, EN 55022



JABLOTRON ALARMS a.s. hereby declares that the JA-111M is in a compliance with the relevant Union harmonisation legislation: Directives No: 2014/30/EU, 2011/65/EU. The original of the conformity assessment can be found at www.jablotron.com - Section Downloads.



Note: Although this product does not contain any harmful materials we suggest you return the product to the dealer or directly to the producer after use.